

Appendix D : ICAO Type A Obstacle Chart and Flightway Obstruction Charts

KELOWNA (CYLW) INTERNATIONAL AIRPORT RUNWAY 16 OBSTACLE INFORMATION				
Number	Feature Description	Elevation (Metres ASL)	Ground Distance (metres) From Threshold Line A-B	Ground Distance Off Centreline (m) From Line C-D
1	BLAST FENCE	438.33	109.0	0.0
2	MOBILE OBSTRUCTION	439.80	116.9	89.4
3	DECIDUOUS TREES	455.14	1024.8	-161.4
4	DECIDUOUS TREES	456.42	1025.4	-139.0
5	EVERGREEN TREES	529.77	3378.4	233.5
6	TRANSMISSION TOWER	541.62	3517.2	316.9

RUNWAY 16-34 OPERATIONAL DATA		
RUNWAY 16		RUNWAY 34
2712.7m/8900ft	TAKE OFF RUN AVAILABLE	2712.7m/8900ft
2712.7m/8900ft	ACCELERATE-STOP DISTANCE AVAILABLE	2712.7m/8900ft
2840.7m/9320ft	TAKE OFF DISTANCE AVAILABLE	2819.7m/9251ft
2347.0m/7700ft	LANDING DISTANCE AVAILABLE	2590.8m/8500ft

KELOWNA (CYLW) INTERNATIONAL AIRPORT RUNWAY 34 OBSTACLE INFORMATION				
Number	Feature Description	Elevation (Metres ASL)	Ground Distance (metres) From Threshold Line A-B	Ground Distance Off Centreline (m) From Line C-D
1	BLAST FENCE	420.45	129.7	0.0
2	MOBILE OBSTRUCTION	421.70	153.6	-64.0
3	TREE	427.41	460.4	-56.1
4	UTILITY POLE	428.44	547.6	-135.0
5	UTILITY POLE	432.90	587.5	146.8
6	NDB TOWER	431.71	604.3	0.0
7	TREE	433.91	670.6	-134.8

PLAN VIEW LEGEND

- TOWER OR ANTENNA
- * - TREE
- MOBILE OBSTRUCTION
- BUILDING OR OBJECT

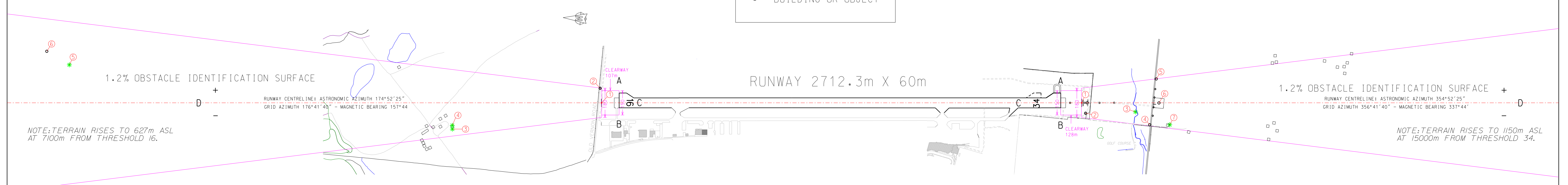

RUNWAY THRESHOLD CO-ORDINATES (UTM Zone 11):

16 - North 5,537,937.26m, East 329,361.27m
Latitude 49°58'09.673" North, Longitude 119°22'46.550" West

34 - N5,535,230.44m, E329,517.61m
Latitude 49°56'42.266" North, Longitude 119°22'34.395" West

NOTES:

- TRUE NORTH IS 1°49'15" EAST OF GRID NORTH (CONVERGENCE)
- MAGNETIC DECLINATION: 17°08' EAST OF TRUE NORTH (2008)
- SURVEY COMPLETED NOVEMBER 2008
- ALL DISTANCES SHOWN IN METRES
- CO-ORDINATE REFERENCE ELLIPSOID: NAD83
- UTM COMBINED SCALE FACTOR 0.999549
- ELEVATIONS REFERRED TO MEAN SEA LEVEL

PROFILE VIEW LEGEND

- 1.2% SLOPE
- ⊙ - OBSTACLE IDENTIFICATION NUMBER
- OBSTACLE SHADOW LINE

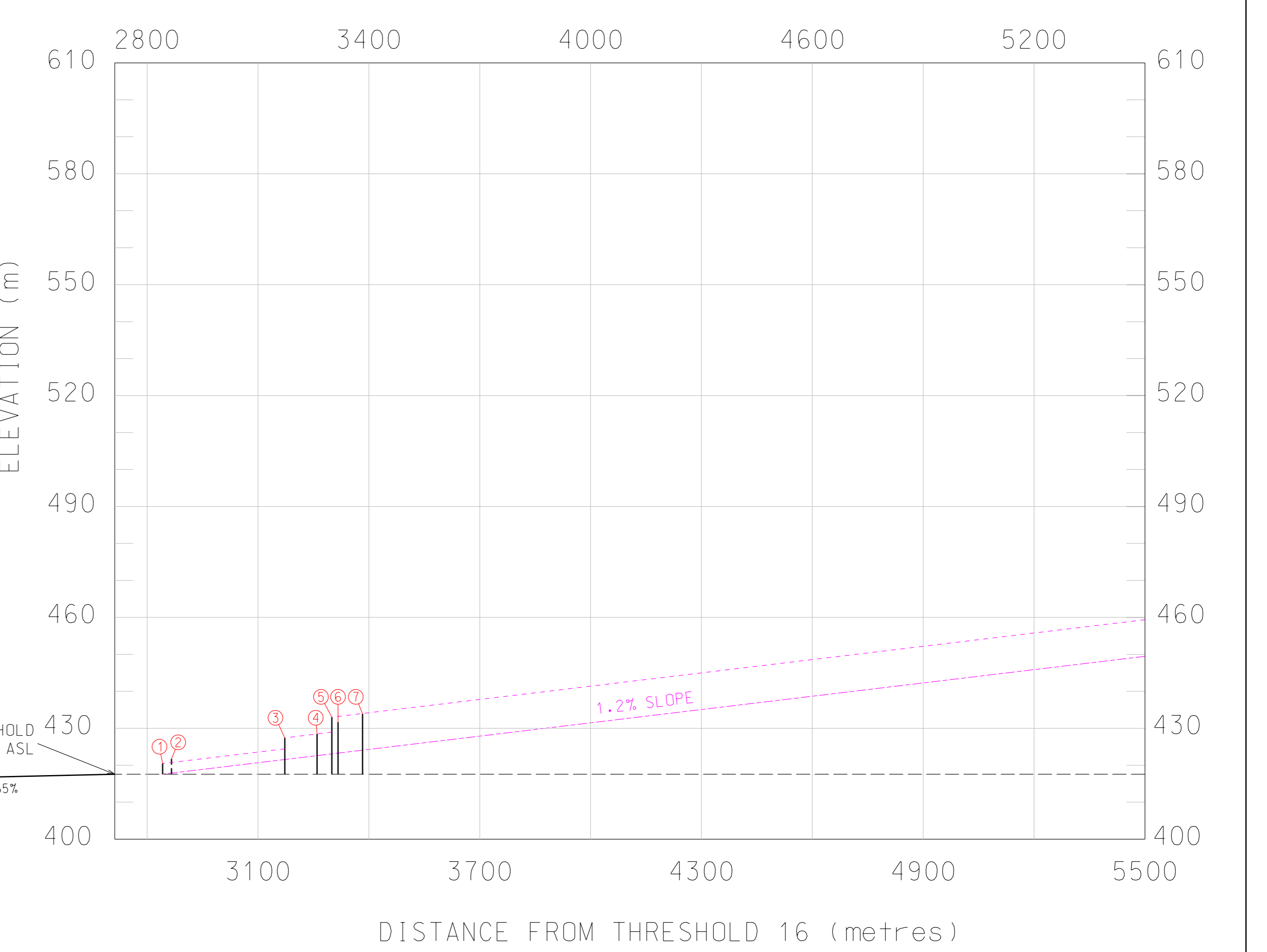
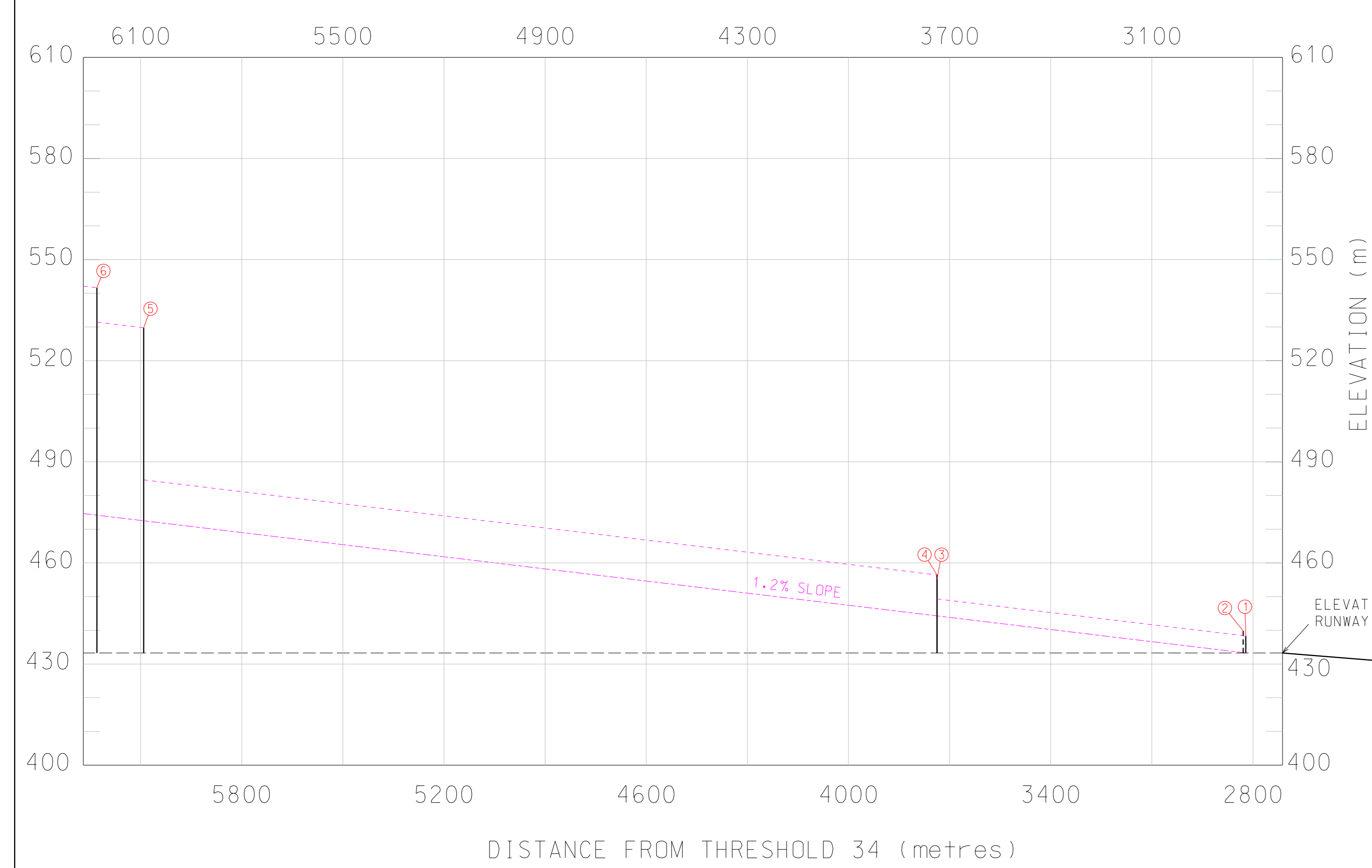

Skyline Surveys
#3 - 4748 53rd Street
Delta, British Columbia
Canada V4K 2Z1
604-831-1156

KELOWNA AIRPORT AUTHORITY

plotting date: 2008/12/30
revised by: _____
drawn by: J. HAY
sheet no: 1 of 1

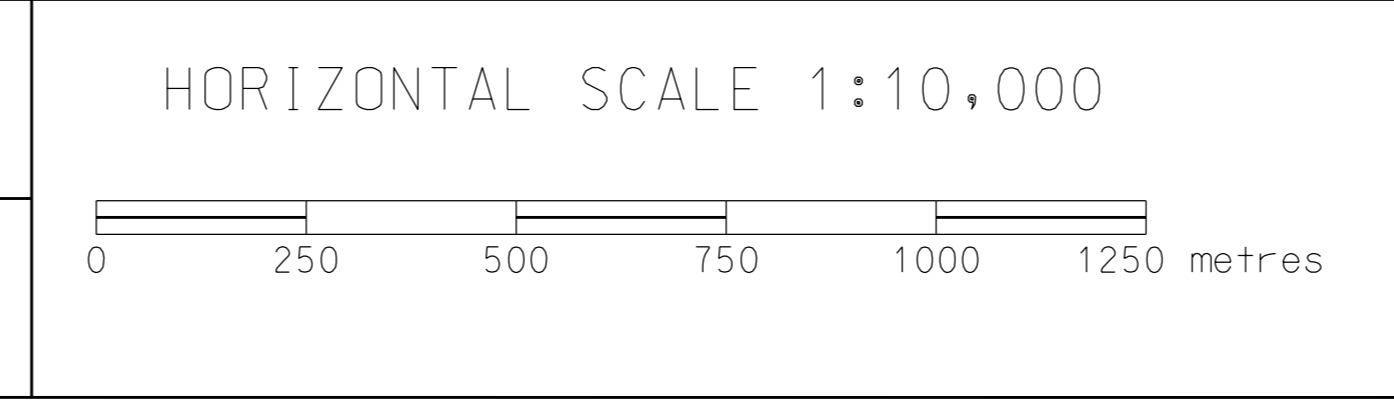

KELOWNA INT. AIRPORT (CYLW)
ICAO TYPE A OBSTACLE CHART
16-34ICAOchart.dgn

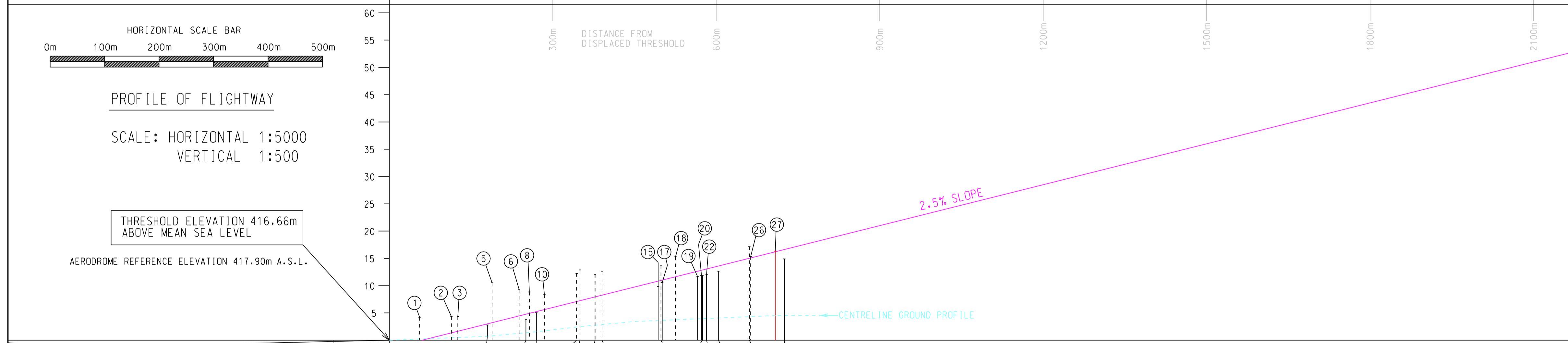
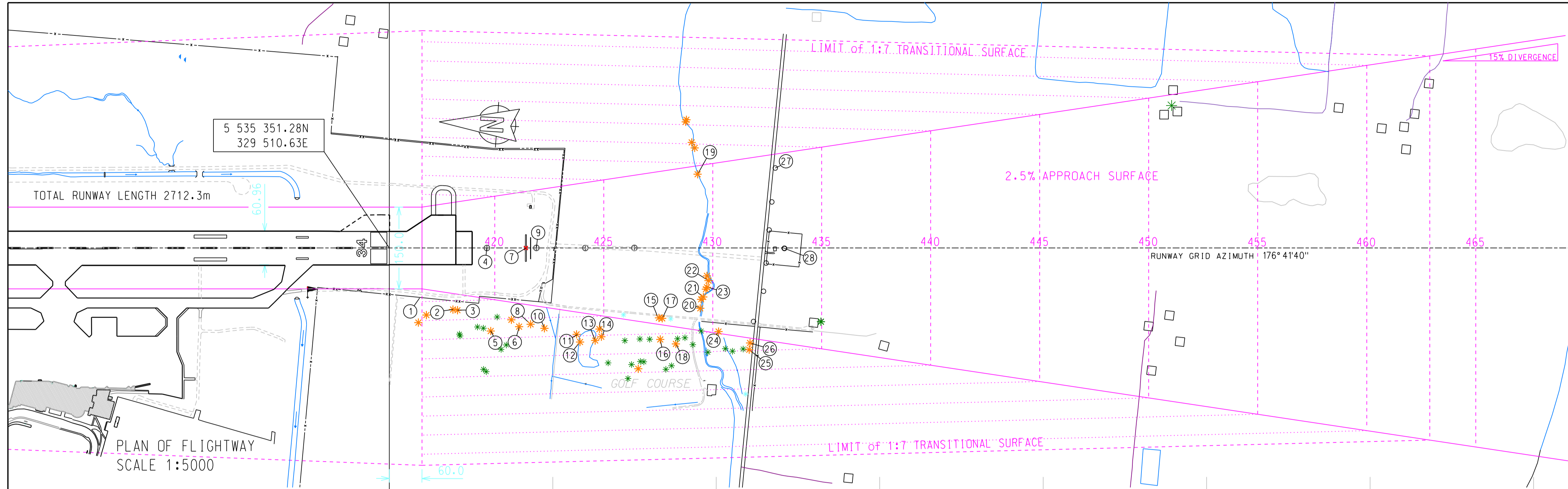

HORIZONTAL SCALE BAR
0m 100m 200m 300m 400m 500m

PROFILE OF FLIGHTWAY
SCALE: HORIZONTAL 1:5000
VERTICAL 1:500

THRESHOLD ELEVATION 416.66m
ABOVE MEAN SEA LEVEL

AERODROME REFERENCE ELEVATION 417.90m A.S.L.

+0.8766% -0.2265%

NOTE: OBJECTS IN TRANSITIONAL SURFACE ARE SHOWN WITH BROKEN LINE.

NOTES:
- ELEVATIONS ARE GEODETIC - REFERRED TO MEAN SEA LEVEL.
- U.T.M. CO-ORDINATES ARE DERIVED FROM AIRPORT CONTROL NETWORK (NAD 83).
- TO OBTAIN GROUND DISTANCE DIVIDE SCALE DISTANCE BY COMBINED SCALE FACTOR 0.999549.

City of Kelowna

OBSTACLES

NO.	DESCRIPTION	ELEVATIONS			CO-ORDINATES	
		TOP	ALLOW	GROUND	NORTH	EAST
1	SCRUB BUSH	420.87	419.06		5535290	329422
2	FIR TREE	421.00	422.11		5535228	329405
3	FIR TREE 512	421.00	422.17		5535220	329404
4	ODAL #1	419.46	419.64	418.1	5535172	329521
5	WILLOW TREE 043	427.20	428.22		5535157	329369
6	WILLOW TREE 439	426.00	427.45		5535105	329379
7	BLAST FENCE	420.45	421.43		5535101	329525
8	WILLOW TREE 041	425.50	427.15	415.4	5535086	329382
9	ODAL #2	421.70	421.91	418.2	5534082	329526
10	WILLOW TREE 040	425.00	427.83	415.2	5535058	329380
11	WILLOW TREE 447	428.90	429.90	415.5	5534998	329371
12	WILLOW TREE F68	429.53	430.72		5534992	329359
13	POPLAR TREE 351	428.77	431.32	414.8	5534965	329363
14	DECIDUOUS TREES	429.20	430.28	415.6	5534952	329371
15	FIR TREE F49	426.50	427.50		5534851	329411
16	DECIDUOUS TREE F50	430.30	431.01		5534844	329375
17	FIR TREE 093	427.24	427.69		5534844	329410
18	DECIDUOUS TREE F47	431.95	432.25		5534817	329369
19	POPLAR TREE	428.30	429.30		5534794	329678
20	DECIDUOUS TREES F29	428.50	429.48		5534773	329434
21	DECIDUOUS TREES F28	428.50	429.53		5534772	329455
22	DECIDUOUS TREES F26	428.70	429.80		5534763	329485
23	DECIDUOUS TREES F27	428.70	429.72		5534766	329473
24	FIR TREE F36	429.30	430.26		5534739	329392
25	FIR TREE F34	433.80	434.79		5534681	329362
26	FIR TREE F32	432.00	433.04		5534679	329374
27	UTILITY POLE	432.90	432.89		5534653	329698
28	NDB ANTENNA	431.71	433.29	421.2	5534627	329552

2	SNC LAVALIN	J.H.		J.H.	FEB. 2013
1	SNC LAVALIN	J.H.		J.H.	OCT. 2011
NO.	SURVEYED BY	CALC. BY	CHECKED BY	DRAWN BY	DATE

REVISION

KELOWNA AIRPORT, B.C.
FLIGHTWAY OBSTRUCTION CHART
RUNWAY 34 APPROACH AT 2.5% SLOPE

drawn by: J. HAY
field by: J. HAY (JULY 95)
checked by:
date: JAN. 96



P 1 3 1 P 9 8 3 C 0 0 2

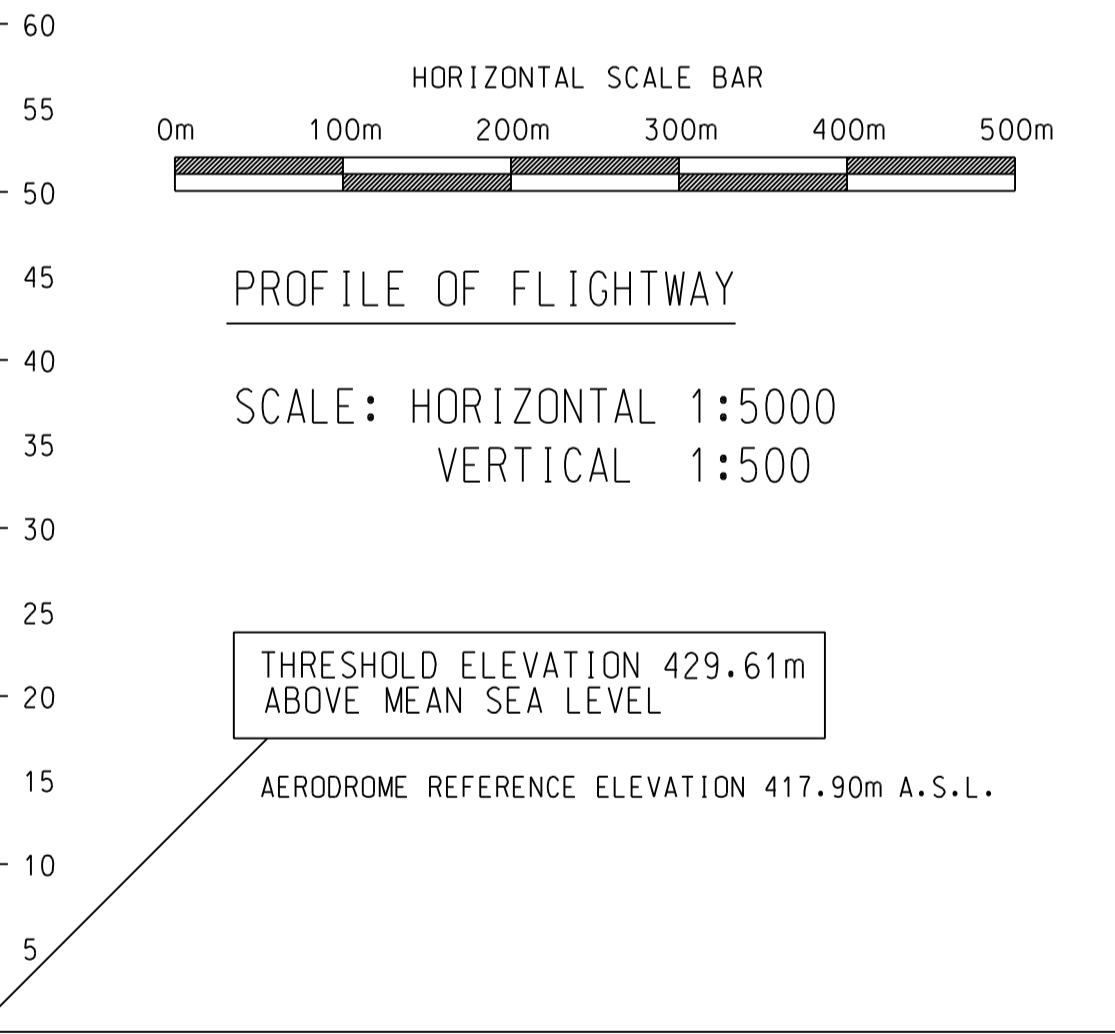
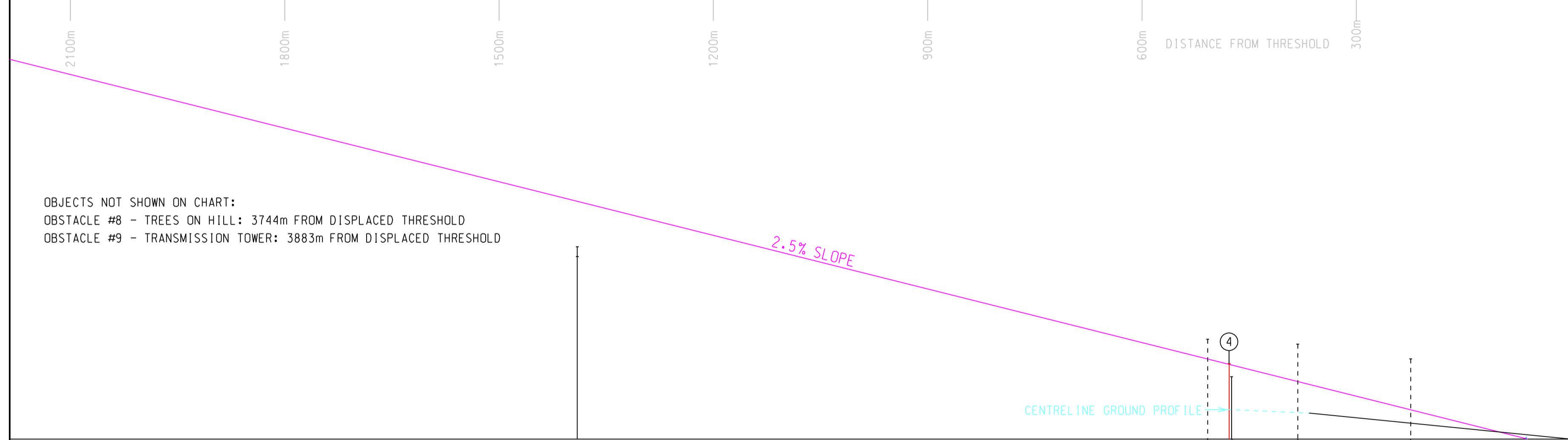
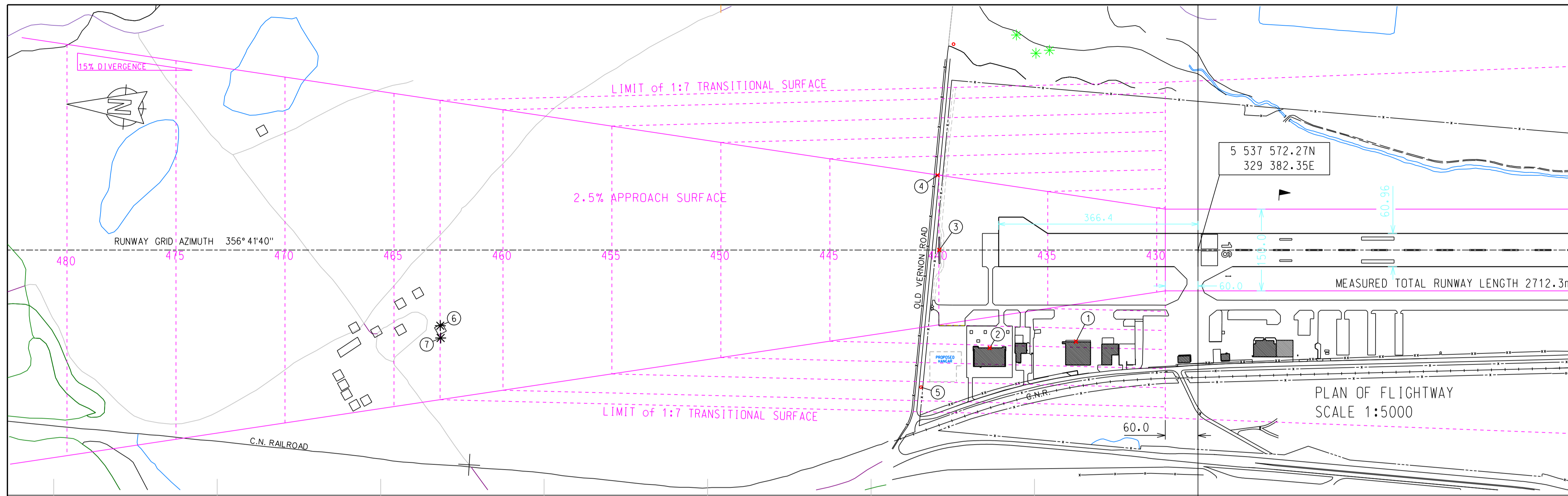

OBJECTS NOT SHOWN ON CHART:
 OBSTACLE #8 - TREES ON HILL: 3744m FROM DISPLACED THRESHOLD
 OBSTACLE #9 - TRANSMISSION TOWER: 3883m FROM DISPLACED THRESHOLD

NOTES:
 - ELEVATIONS ARE GEODETIC - REFERRED TO MEAN SEA LEVEL.
 - U.T.M. CO-ORDINATES ARE DERIVED FROM AIRPORT CONTROL NETWORK (NAD 83).
 - TO OBTAIN GROUND DISTANCE DIVIDE SCALE DISTANCE BY COMBINED SCALE FACTOR 0.999549.

NOTE: OBJECTS IN TRANSITIONAL SURFACE ARE SHOWN WITH BROKEN LINE.

City of Kelowna

OBSTACLES

NO.	DESCRIPTION	ELEVATIONS			CO-ORDINATES	
		TOP	ALLOW	GROUND	NORTH	EAST
1	BUILDING PEAK	440.90	443.50		5537786	329202
2	BUILDING PEAK	442.94	445.69		5537943	329181
3	BLAST FENCE	438.34	439.98		5538046	329355
4	MOBILE OBSTRUCTION	440.17	440.06	435.87	5538057	329492
5	UTILITY POLE	443.58	456.45		5538065	329102
6	FIR TREE	456.75	462.79		5538952	329164
7	POPLAR GROUP	454.58	462.77		5538950	329141
8	TREES ON HILL	529.77	521.71		5541322	329400
9	TRANSMISSION TOWER	541.62	525.18		5541465	329475

PLAN OF FLIGHTWAY
SCALE 1:5000

MEASURED TOTAL RUNWAY LENGTH 2712.3m

2	SNC LAVALIN	J.H.	J.H.	MAR.2013	
1	SNC LAVALIN	J.H.	J.H.	DEC.2010	
NO.	SURVEYED BY	CALC. BY	CHECKED BY	DRAWN BY	DATE

REVISION

KELOWNA AIRPORT, B.C.
 FLIGHTWAY OBSTRUCTION CHART
 RUNWAY 16 APPROACH AT 2.5% SLOPE

drawn by: J.HAY
 field by: J.HAY (JULY 95)
 checked by:
 date: JAN. 1996



P 1 3 1 P 9 8 3 C 0 0 1

